

## *Grand Cabinet 3D Vignettes*

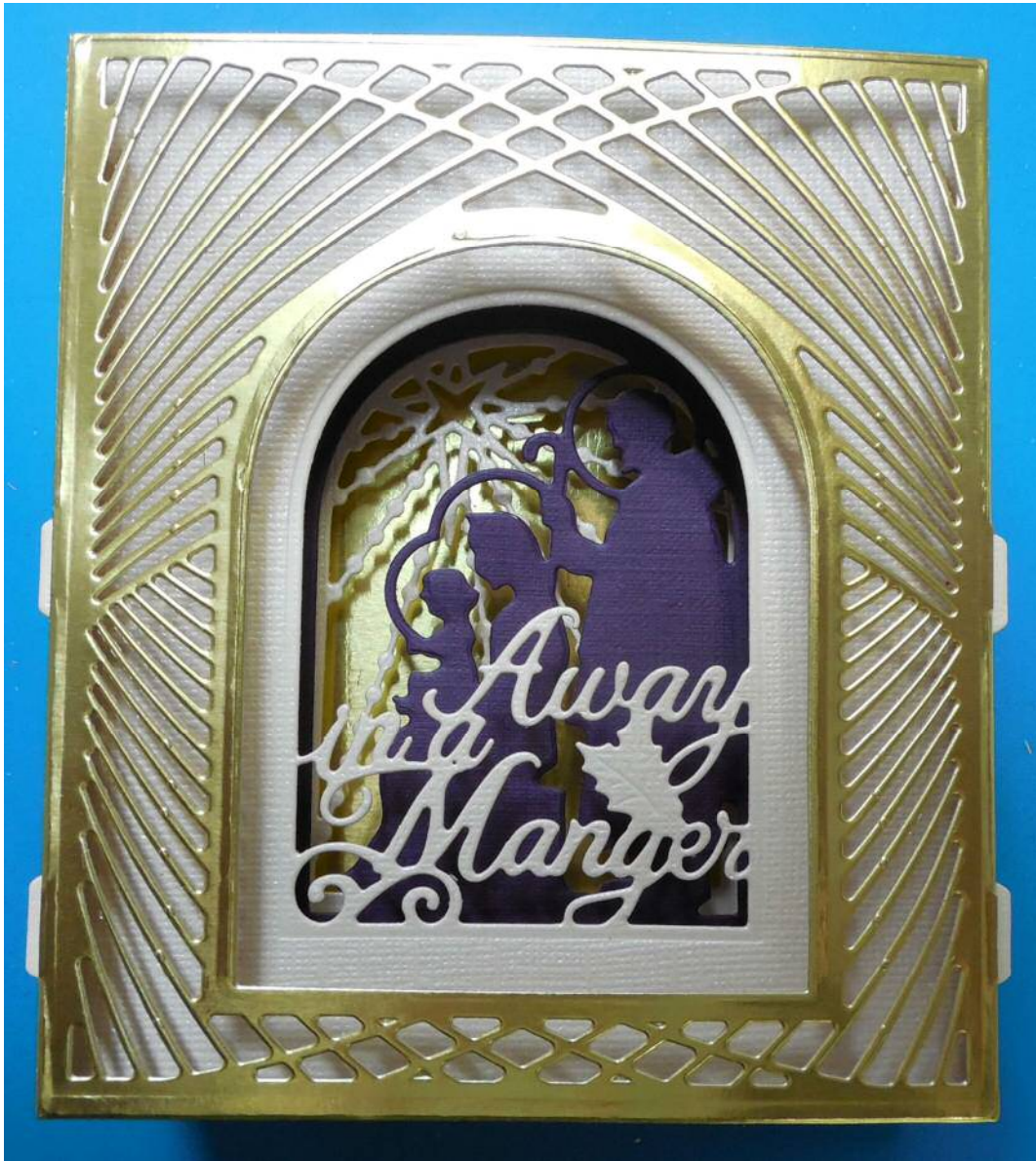

### Materials:

Spellbinders S6-159 Grand Christmas Lattice Arch

Spellbinders S4-1006 Nativity Layering set

Assorted cardstocks (Tim Holtz Metallic Confections paper pad and Bazzill plain used in sample)

1/8" scor tape

Die Cut machine such as Sizzix Big Shot

Optional: magnetic platform ( if you don't have one, you can use washi tape to hold dies in place)

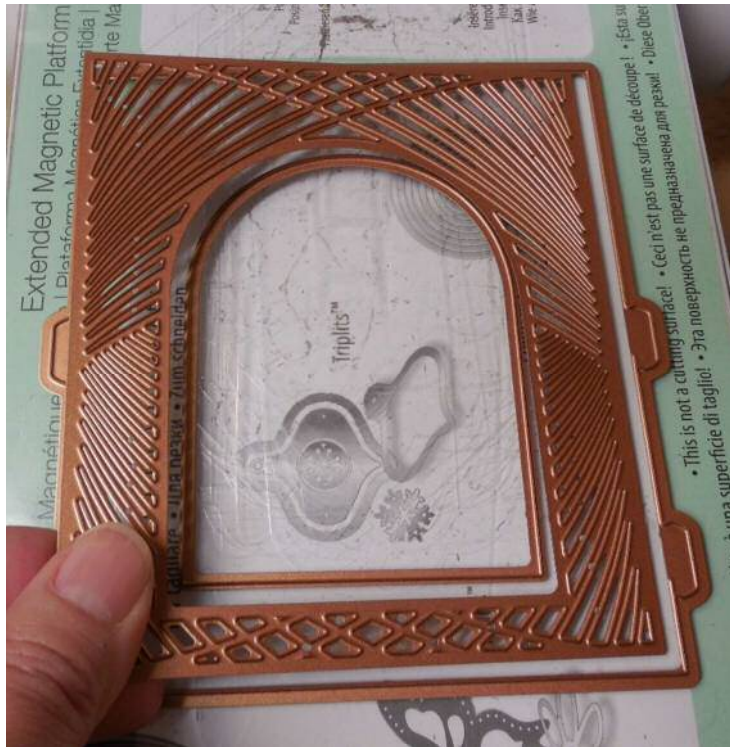

Select the tabbed outline die, the lattice pattern front cover die, and the arch outline die.

Place them on your machine plate as shown with the cutting side up. Place the paper on top and die cut as usual with your machine's "sandwich" guidelines for thin dies.

See photo below for what the piece should look like coming out of the die.

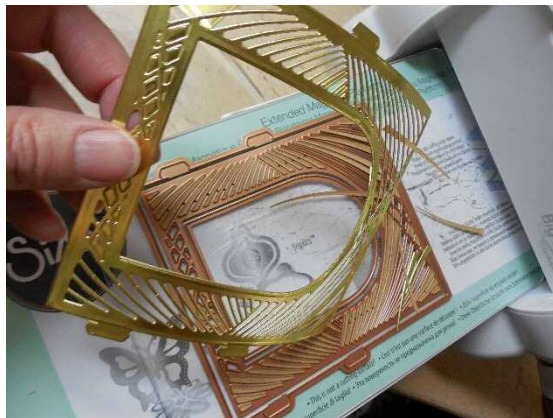

Select tabbed outline die and Away in the Manger die. Use the lattice cover to position where Away in the Manger die goes, but then remove it.



Cut the Holy Family die and the Star arch die using the same technique as shown above:



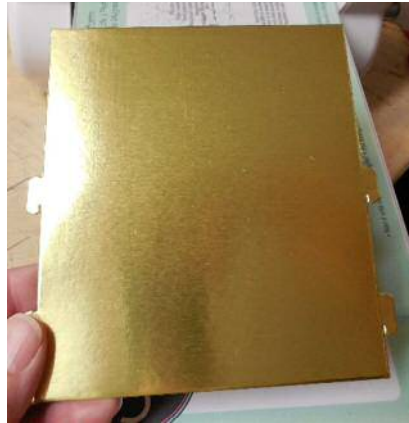

Cut two tabbed panels using the Tabbed Outline die alone. One from the metallic and one from plain ivory cardstock.



Place the outline side panel die and the slot side panel die together on the cutting platform. Cut two side panels from the metallic paper. It will score the fold lines and cut the slots for you at the same time.



Shown at left are all the parts you need, PLUS you need one more plain tabbed panel in ivory that is not shown. It is the panel that completes the back of the 3D piece.



Fold the side tabs along the score lines as shown.



Starting with the panel that is furthest back, in this case the plain gold background, insert the tabs into the slots. Be sure to slide the tabs down even with the bottom of the side panels. Notice the tabs have a little hook to them that helps anchor them in the slots. Insert the tabs into the other side panel as well.

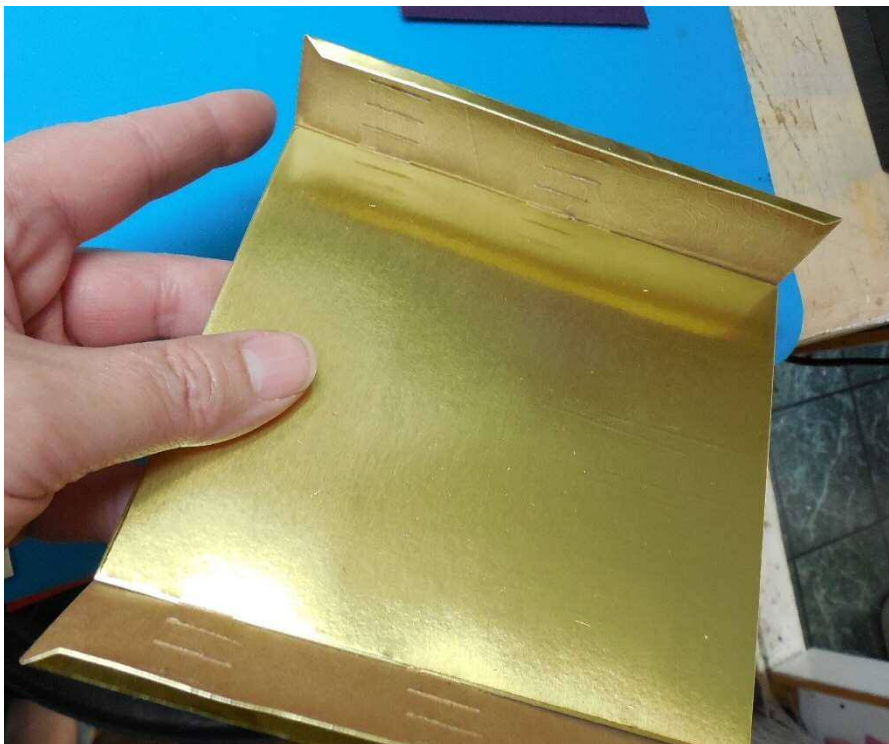

As you can see, the back panel should be seated in the last set of slots toward the back of what will be the finished 3D vignette.





Now work your way toward the front, one panel at a time, as shown above.

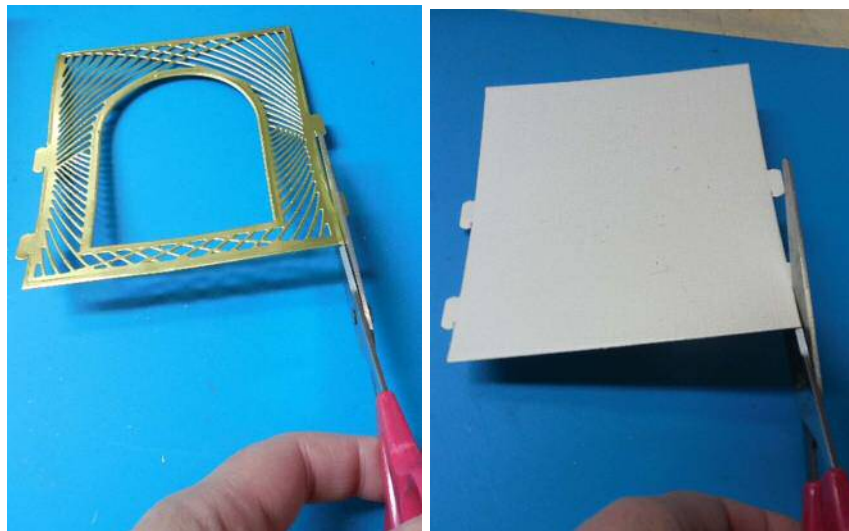

Cut the tabs off the front cover lattice piece and the back ivory panel.



Put Scor-tape on the folded edges of the side panels on both the front of the piece and the back.



Place the lattice front panel flush with the edge of the side panel, securing against the scor-tape you just applied. Secure the other edge in place in the same manner. Now turn over to the back and apply the ivory back panel the same way, so that you now have a completely enclosed "box".



If you push on the finished piece, you can fold it flat to fit in an A7 envelope. When the recipient opens it and pulls the piece out, it will pop back into the 3D form!





All the 3D Vignettes go together in the same manner. Try mixing and matching from different sets to get a variety of results.  
Also try layering them flat on a card front as shown on the Santa card above.